

LEGEND 1:

- ACM Wall Texture & Joint Compound to be removed (Approx. 4,704 SF)
- ACM Ceiling Texture & Joint Compound to be removed (Approx. 1,588 SF)
- ACM Flooring Materials to be removed (Approx. 440 SF)
- ACM TSI in crawlspace to be removed (Approx. 175 LF)

LEGEND 2:

- Containment Barrier
- Air Filter Device (AFD)
- AFD Exhaust Route
- ER** Equipment (dirty) Room
- SR** Shower Room
- CR** Clean Room
- BO1** Waste Bags Wash Down Room
- BO2** Double Bagging of Waste Room

FIGURE 1

Asbestos-Containing Materials Abatement

Residential Duplex
 2 & 2A Perrin Street, TSTC Campus
 3801 Campus Drive
 Waco, Texas 76705

BENAS Project No.: BA-11-0989



ENVIRONMENTAL CONSULTANTS
 P.O. BOX 739
 COPPELL, TEXAS 75019
 PHONE: (972)393-0128 FAX: (972) 393-0793

HATCHING & LOCATIONS FOR ASBESTOS-CONTAINING MATERIALS TO BE REMOVED

Prepared for: Texas State Technical College (TSTC)
 Attention: Mr. Mike Ratliff, Project Manager
 Prepared by: Ephraim Okotcha "EO"
 TDSHS Licensed Asbestos Consultant No.: 10-5399

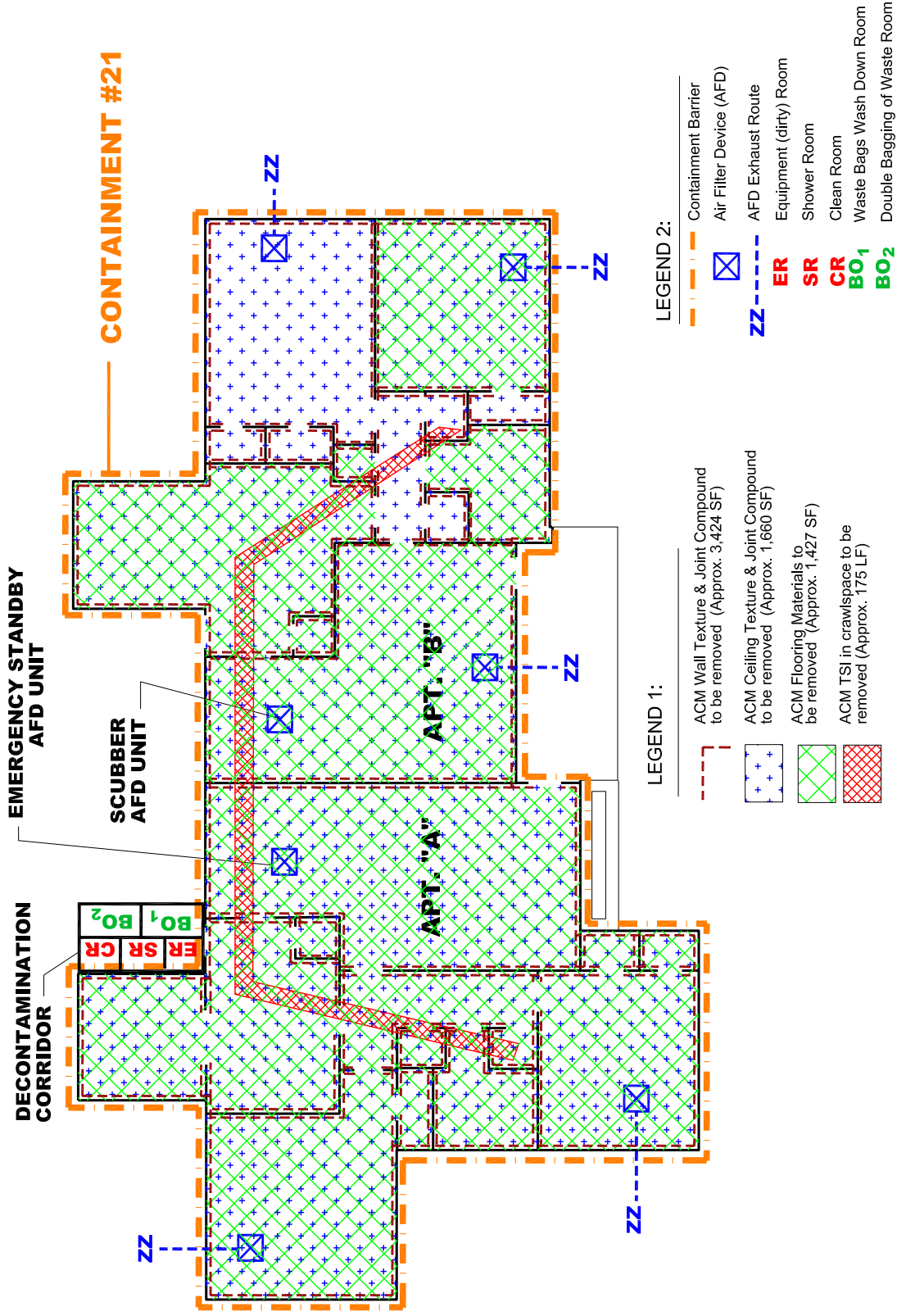
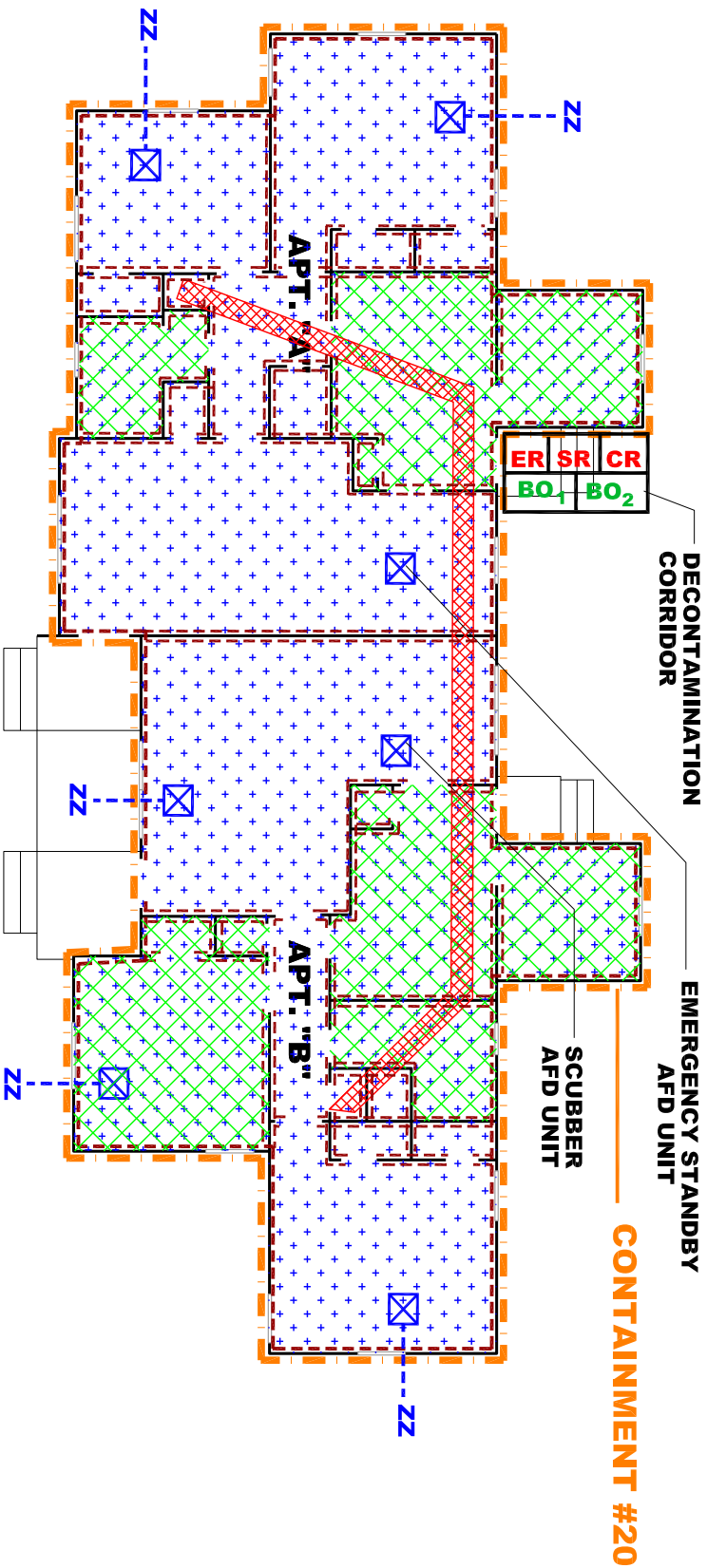

FIGURE 21

Asbestos-Containing Materials Abatement
 Residential Duplex
 75 & 75A Bolling, TSTC Campus
 3801 Campus Drive
 Waco, Texas 76705
BENAS Project No.: BA-11-0989

BENAS
 Environmental Services, Inc.
 ENVIRONMENTAL CONSULTANTS
 P.O. BOX 739
 COPPELL, TEXAS 75019
 PHONE: (972)393-0128 FAX: (972) 393-0793

HATCHING & LOCATIONS FOR ASBESTOS-CONTAINING MATERIALS TO BE REMOVED
 Prepared for: Texas State Technical College (TSTC)
 Attention: Mr. Mike Ratliff, Project Manager
 Prepared by: Ephraim Okotcha "EO"
 TDSHS Licensed Asbestos Consultant No.: 10-5399



- LEGEND 1:**
- ACM Wall Texture & Joint Compound to be removed (Approx. 4,160 SF)
 - ACM Ceiling Texture & Joint Compound to be removed (Approx. 1,550 SF)
 - ACM Flooring Materials to be removed (Approx. 570 SF)
 - ACM TSI in crawlspace to be removed (Approx. 175 LF)

- LEGEND 2:**
- Containment Barrier
 - Air Filter Device (AFD)
 - AFD Exhaust Route
 - ER** Equipment (dirty) Room
 - SR** Shower Room
 - CR** Clean Room
 - BO₁** Waste Bags Wash Down Room
 - BO₂** Double Bagging of Waste Room

FIGURE 20

Asbestos-Containing Materials Abatement

Residential Duplex
 73 and 73-A Boiling Drive, TSTC Campus
 3801 Campus Drive
 Waco, Texas 76705
BENAS Project No.: BA-11-0989



BENAS
 Environmental Services, Inc.
 ENVIRONMENTAL CONSULTANTS
 P.O. BOX 739
 COPPELL, TEXAS 75019
 PHONE: (972)393-0128

PHON: (972) 393-0128 FAX: (972) 393-0793

HATCHING & LOCATIONS FOR
 ASBESTOS-CONTAINING MATERIALS
 TO BE REMOVED

Prepared for: Texas State Technical College (TSTC)
 Attention: Mr. Mike Ratliff, Project Manager
 Prepared by: Ephraim Okotcha "EO"
 TDSHS Licensed Asbestos Consultant No.: 10-5399

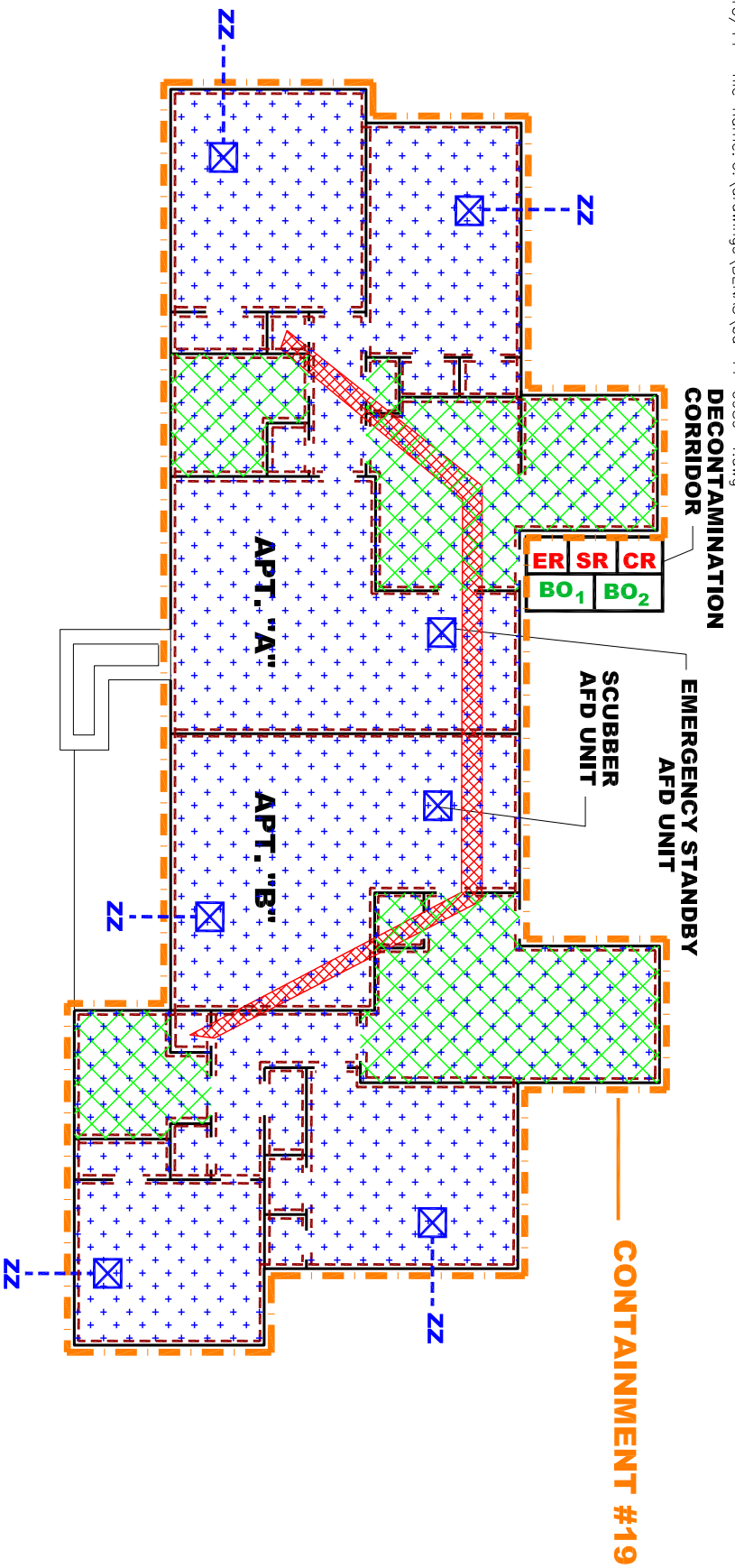

- LEGEND 1:**
- ACM Wall Texture & Joint Compound to be removed (Approx. 4,512 SF)
 - ACM Ceiling Texture & Joint Compound to be removed (Approx. 1,346 SF)
 - ACM Flooring Materials to be removed (Approx. 440 SF)
 - ACM TSI in crawlspace to be removed (Approx. 175 LF)
- LEGEND 2:**
- Containment Barrier
 - Air Filter Device (AFD)
 - AFD Exhaust Route
 - ER** Equipment (dirty) Room
 - SR** Shower Room
 - CR** Clean Room
 - BO₁** Waste Bags Wash Down Room
 - BO₂** Double Bagging of Waste Room

FIGURE 19

Asbestos-Containing Materials Abatement

Residential Duplex
 14 & 14A Carrswell Street, TSTC Campus
 3801 Campus Drive
 Waco, Texas 76705
BENAS Project No.: BA-11-0989





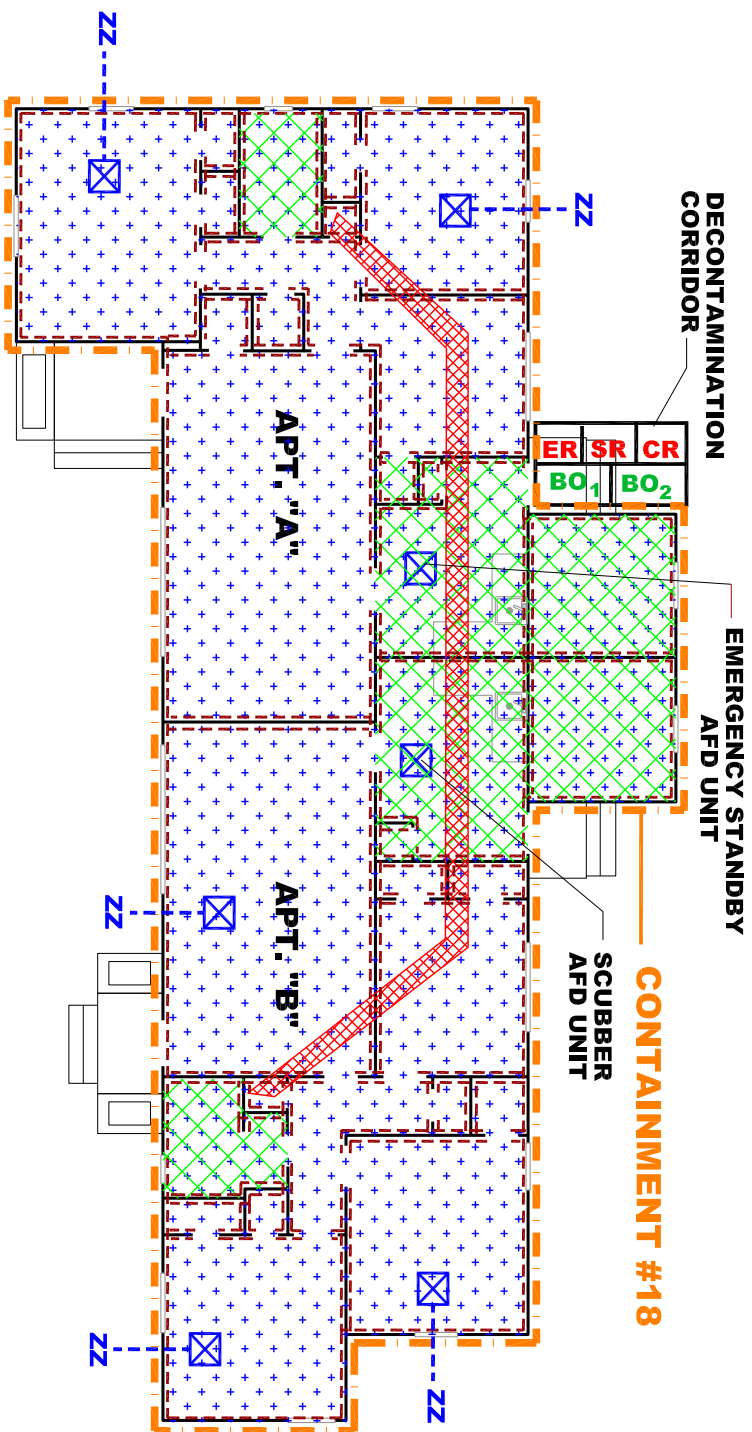

BENAS
 Environmental Services, Inc.
 ENVIRONMENTAL CONSULTANTS
 P.O. BOX 739
 COPPELL, TEXAS 75019
 PHONE: (972)393-0128 FAX: (972) 393-0793

HATCHING & LOCATIONS FOR ASBESTOS-CONTAINING MATERIALS TO BE REMOVED

Prepared for: Texas State Technical College (TSTC)
 Attention: Mr. Mike Ratliff, Project Manager
 Prepared by: Ephraim Okotcha "EO"
 TDSHS Licensed Asbestos Consultant No.: 10-5399



LEGEND 1:

-  ACM Wall Texture & Joint Compound to be removed (Approx. 4,688 SF)
-  ACM Ceiling Texture & Joint Compound to be removed (Approx. 1,982 SF)
-  ACM Flooring Materials to be removed (Approx. 440 SF)
-  ACM TSI in crawlspace to be removed (Approx. 175 LF)

LEGEND 2:







-  Containment Barrier
-  Air Filter Device (AFD)
-  AFD Exhaust Route
-  ER Equipment (dirty) Room
-  SR Shower Room
-  CR Clean Room
-  BO₁ Waste Bags Wash Down Room
-  BO₂ Double Bagging of Waste Room

FIGURE 18

Asbestos-Containing Materials Abatement

Residential Duplex
 12 and 12-A Carswell Drive, TSTC Campus
 3801 Campus Drive
 Waco, Texas 76705
BENAS Project No.: BA-11-0989



BENAS
 Environmental Services, Inc.
 ENVIRONMENTAL CONSULTANTS
 P.O. BOX 739
 COPPELL, TEXAS 75019

PHONE: (972)393-0128 FAX: (972) 393-0793

HATCHING & LOCATIONS FOR ASBESTOS-CONTAINING MATERIALS TO BE REMOVED

Prepared for: Texas State Technical College
 Attention: Mr. Mike Ratliff, Project Manager
 Prepared by: Ephraim Okotcha "EO"
 TDSHS Licensed Asbestos Consultant No.: 10-5399

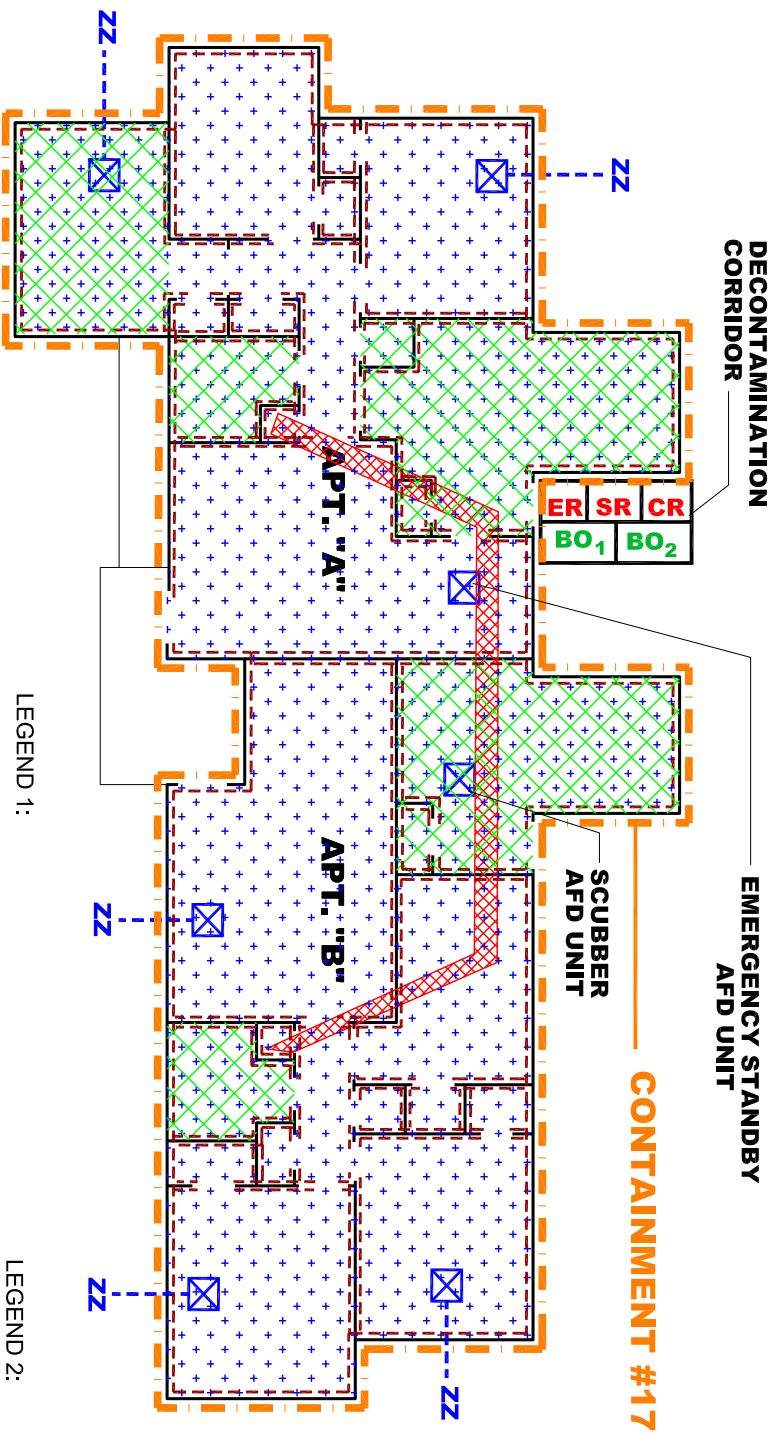

- LEGEND 1:**
- ACM Wall Texture & Joint Compound to be removed (Approx. 4,816 SF)
 - ACM Ceiling Texture & Joint Compound to be removed (Approx. 1,928 SF)
 - ACM Flooring Materials to be removed (Approx. 584 SF)
 - ACM TSI in crawlspace to be removed (Approx. 175 LF)

- LEGEND 2:**
- Containment Barrier
 - Air Filter Device (AFD)
 - AFD Exhaust Route
 - ER** Equipment (dirty) Room
 - SR** Shower Room
 - CR** Clean Room
 - BO₁** Waste Bags Wash Down Room
 - BO₂** Double Bagging of Waste Room

FIGURE 17

Asbestos-Containing Materials Abatement

Residential Duplex
 10 and 10-A Carswell Drive, TSTC Campus
 3801 Campus Drive
 Waco, Texas 76705
BENAS Project No.: BA-11-0989



ENVIRONMENTAL CONSULTANTS
 P.O. BOX 739
 COPPELL, TEXAS 75019
 PHONE: (972)393-0128 FAX: (972) 393-0793

HATCHING & LOCATIONS FOR ASBESTOS-CONTAINING MATERIALS TO BE REMOVED

Prepared for: Texas State Technical College (TSTC)
 Attention: Mr. Mike Ratliff, Project Manager
 Prepared by: Ephraim Okotcha "EO"
 TDSHS Licensed Asbestos Consultant No.: 10-5399

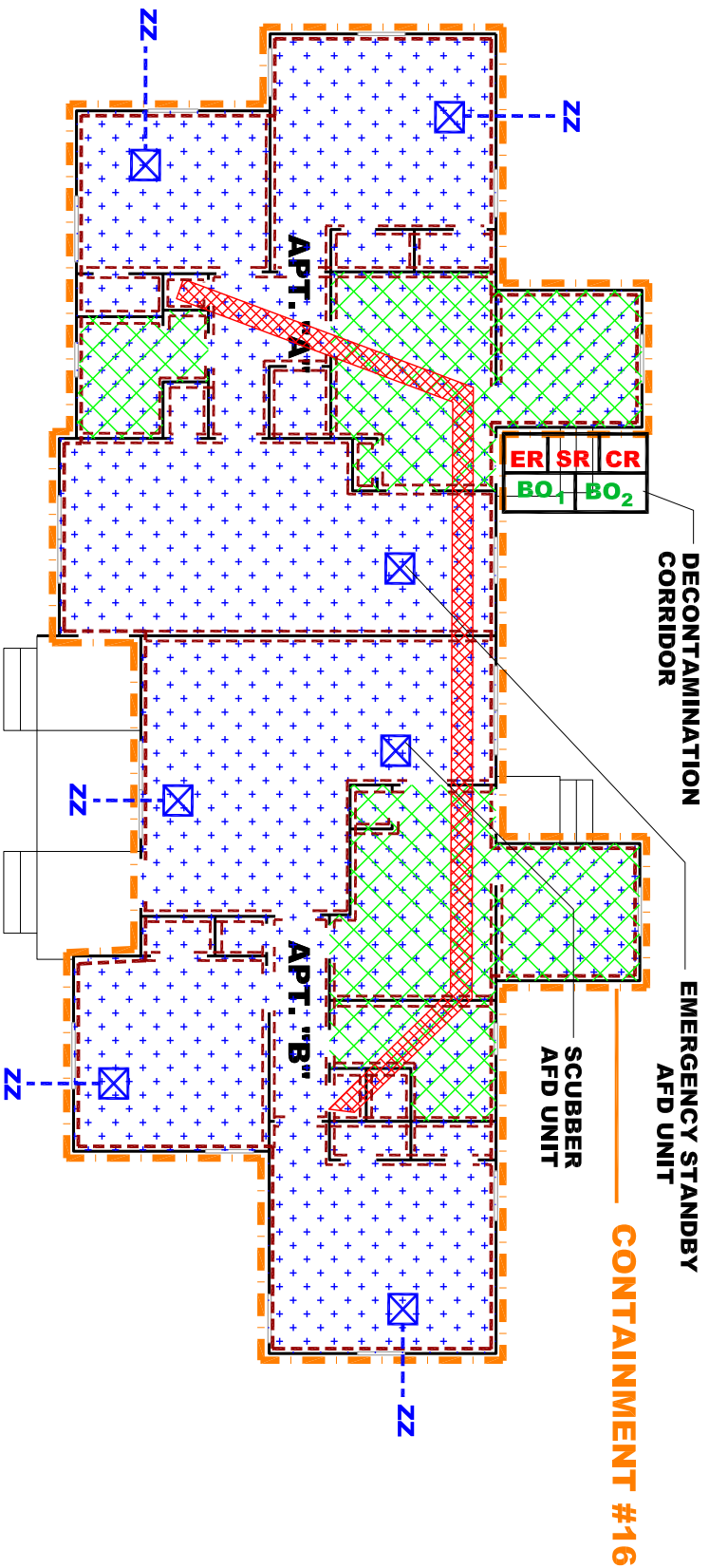

- LEGEND 1:**
- ACM Wall Texture & Joint Compound to be removed (Approx. 4,160 SF)
 - ACM Ceiling Texture & Joint Compound to be removed (Approx. 1,550 SF)
 - ACM Flooring Materials to be removed (Approx. 440 SF)
 - ACM TSI in crawlspace to be removed (Approx. 175 LF)

- LEGEND 2:**
- Containment Barrier
 - Air Filter Device (AFD)
 - AFD Exhaust Route
 - ER** Equipment (dirty) Room
 - SR** Shower Room
 - CR** Clean Room
 - BO₁** Waste Bags Wash Down Room
 - BO₂** Double Bagging of Waste Room

FIGURE 16

Asbestos-Containing Materials Abatement

Residential Duplex
 19 and 19-A Mather Drive, TSTC Campus
 3801 Campus Drive
 Waco, Texas 76705
BENAS Project No.: BA-11-0989



BENAS
 Environmental Services, Inc.
 ENVIRONMENTAL CONSULTANTS
 P.O. BOX 739
 COPPELL, TEXAS 75019
 PHONE: (972)393-0128 FAX: (972) 393-0793

HATCHING & LOCATIONS FOR ASBESTOS-CONTAINING MATERIALS TO BE REMOVED

Prepared for: Texas State Technical College (TSTC)
 Attention: Mr. Mike Ratliff, Project Manager
 Prepared by: Ephraim Okotcha "EO"
 TDSHS Licensed Asbestos Consultant No.: 10-5399

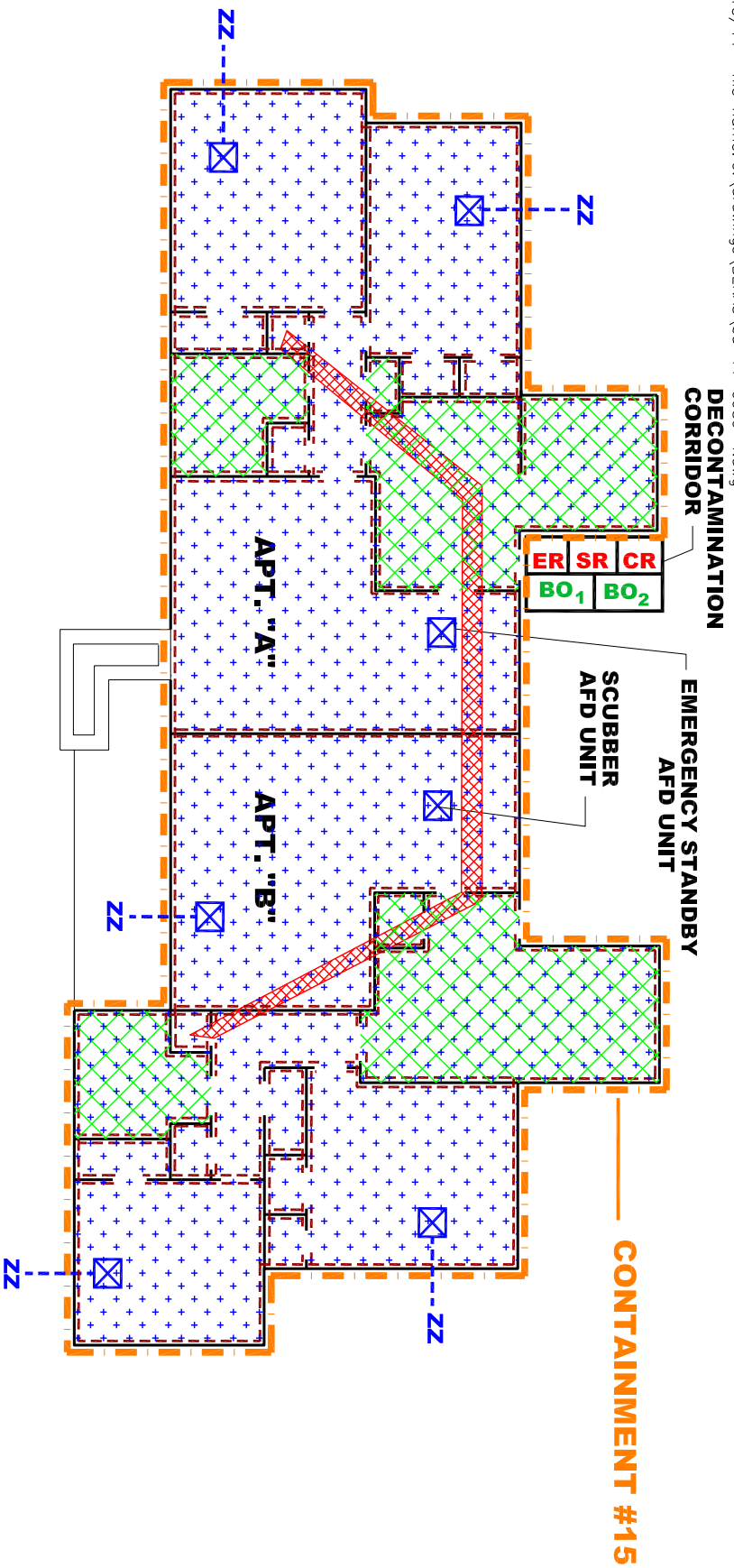

LEGEND 1:

- ACM Wall Texture & Joint Compound to be removed (Approx. 4,512 SF)
- ACM Ceiling Texture & Joint Compound to be removed (Approx. 1,346 SF)
- ACM Flooring Materials to be removed (Approx. 440 SF)
- ACM TSI in crawlspace to be removed (Approx. 175 LF)

LEGEND 2:

- Containment Barrier
- Air Filter Device (AFD)
- AFD Exhaust Route
- ER** Equipment (dirty) Room
- SR** Shower Room
- CR** Clean Room
- BO₁** Waste Bags Wash Down Room
- BO₂** Double Bagging of Waste Room

FIGURE 15

Asbestos-Containing Materials Abatement

Residential Duplex
 17 & 17A Mather Street, TSTC Campus
 3801 Campus Drive
 Waco, Texas 76705
BENAS Project No.: BA-11-0989



BENAS
 Environmental Services, Inc.



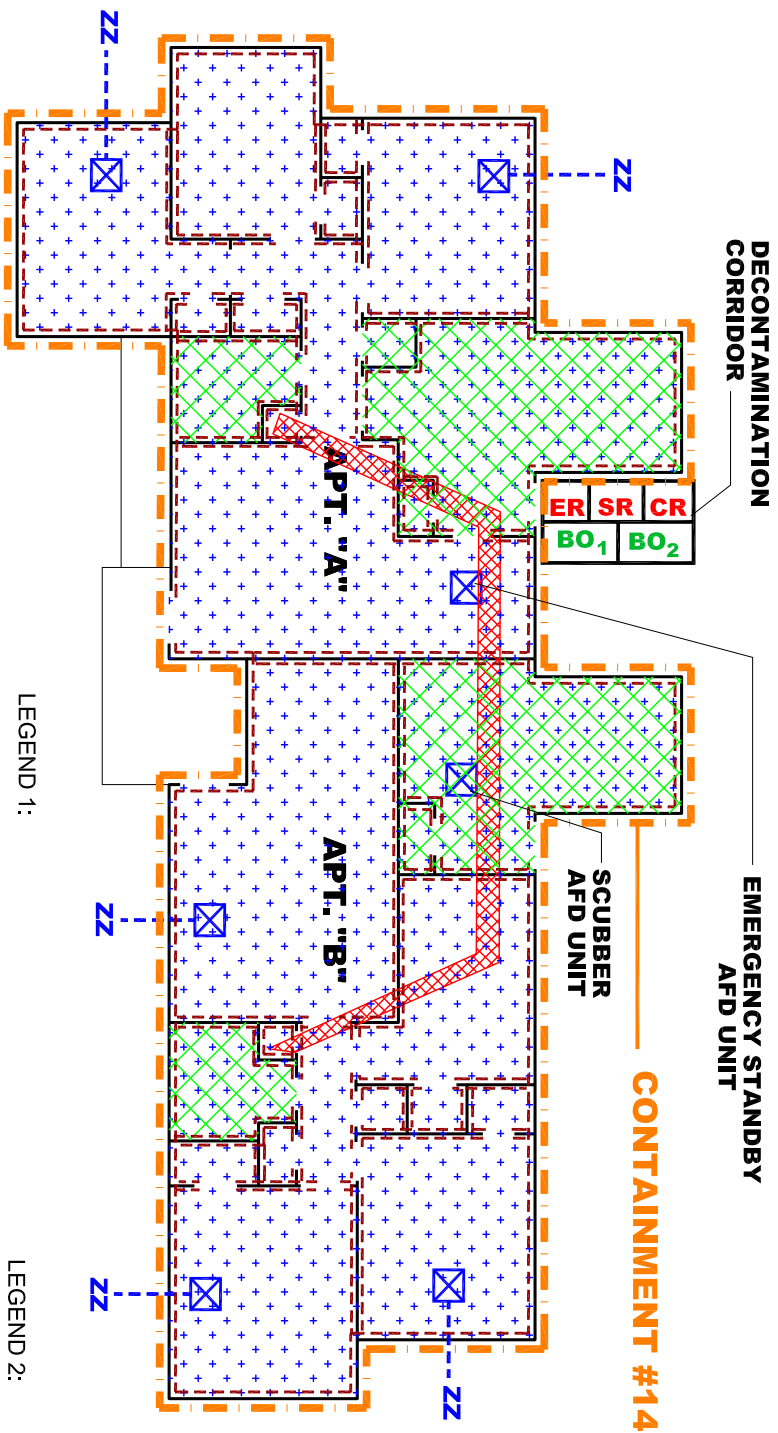

ENVIRONMENTAL CONSULTANTS
 P.O. BOX 739
 COPPELL, TEXAS 75019
 PHONE: (972)393-0128 FAX: (972) 393-0793

HATCHING & LOCATIONS FOR ASBESTOS-CONTAINING MATERIALS TO BE REMOVED

Prepared for: Texas State Technical College (TSTC)
 Attention: Mr. Mike Ratliff, Project Manager
 Prepared by: Ephraim Okotcha "EO"
 TDSHS Licensed Asbestos Consultant No.: 10-5399



LEGEND 1:

-  ACM Wall Texture & Joint Compound to be removed (Approx. 4,816 SF)
-  ACM Ceiling Texture & Joint Compound to be removed (Approx. 1,928 SF)
-  ACM Flooring Materials to be removed (Approx. 440 SF)
-  ACM TSI in crawlspace to be removed (Approx. 175 LF)

LEGEND 2:



-  Containment Barrier
-  Air Filter Device (AFD)
-  AFD Exhaust Route
- ER** Equipment (dirty) Room
- SR** Shower Room
- CR** Clean Room
- BO₁** Waste Bags Wash Down Room
- BO₂** Double Bagging of Waste Room

FIGURE 14

Asbestos-Containing Materials Abatement

Residential Duplex
 9 and 9-A Mather Drive, TSTC Campus
 3801 Campus Drive
 Waco, Texas 76705
BENAS Project No.: BA-11-0989



BENAS
 Environmental Services, Inc.
 ENVIRONMENTAL CONSULTANTS
 P.O. BOX 739
 COPPELL, TEXAS 75019

PHONE: (972)393-0128 FAX: (972) 393-0793

HATCHING & LOCATIONS FOR ASBESTOS-CONTAINING MATERIALS TO BE REMOVED

Prepared for: Texas State Technical College (TSTC)
 Attention: Mr. Mike Ratliff, Project Manager
 Prepared by: Ephraim Okotcha "EO"
 TDSHS Licensed Asbestos Consultant No.: 10-5399

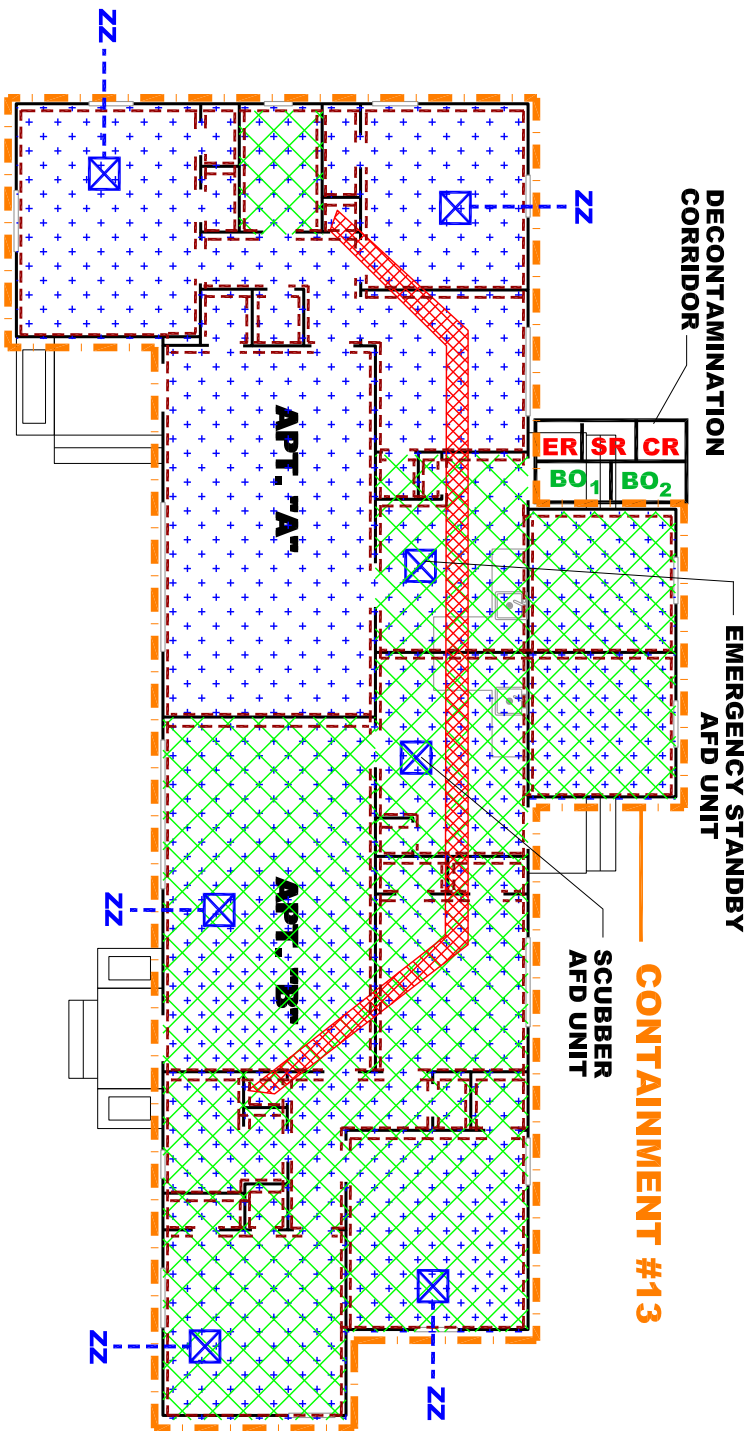

LEGEND 1:

- ACM Wall Texture & Joint Compound to be removed (Approx. 4,688 SF)
- ACM Ceiling Texture & Joint Compound to be removed (Approx. 1,982 SF)
- ACM Flooring Materials to be removed (Approx. 1,211 SF)
- ACM TSI in crawlspace to be removed (Approx. 175 LF)

LEGEND 2:

- Containment Barrier
- Air Filter Device (AFD)
- AFD Exhaust Route
- ER** Equipment (dirty) Room
- SR** Shower Room
- CR** Clean Room
- BO₁** Waste Bags Wash Down Room
- BO₂** Double Bagging of Waste Room

FIGURE 13

Asbestos-Containing Materials Abatement

Residential Duplex
 7 and 7-A Mather Drive, TSTC Campus
 3801 Campus Drive
 Waco, Texas 76705
BENAS Project No.: BA-11-0989



ENVIRONMENTAL CONSULTANTS
 P.O. BOX 739
 COPPELL, TEXAS 75019
 PHONE: (972)393-0128 FAX: (972) 393-0793

HATCHING & LOCATIONS FOR ASBESTOS-CONTAINING MATERIALS TO BE REMOVED

Prepared for: Texas State Technical College (TSTC)
 Attention: Mr. Mike Ratliff, Project Manager
 Prepared by: Ephraim Okotcha "EO"
 TDSHS Licensed Asbestos Consultant No.: 10-5399

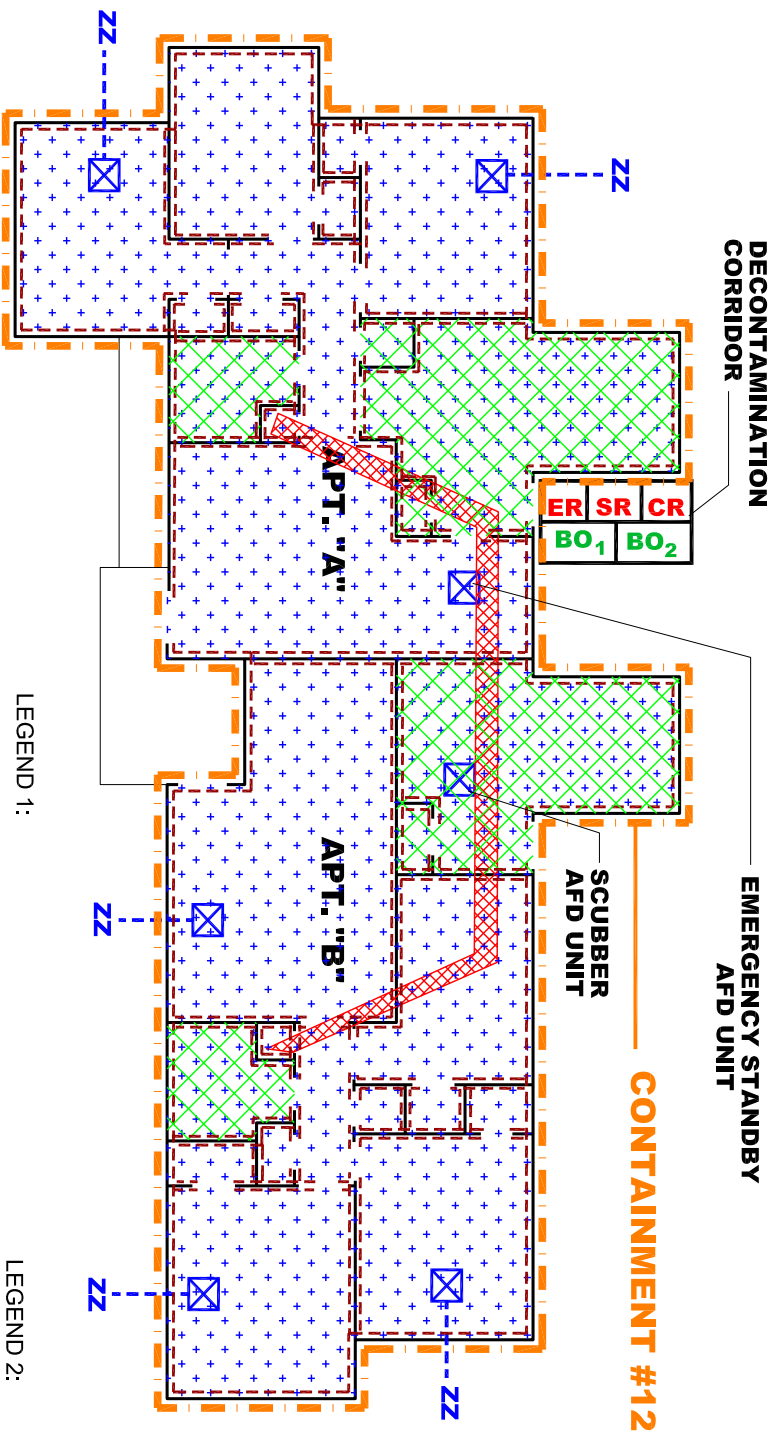

- LEGEND 1:**
- ACM Wall Texture & Joint Compound to be removed (Approx. 4,816 SF)
 - ACM Ceiling Texture & Joint Compound to be removed (Approx. 1,928 SF)
 - ACM Flooring Materials to be removed (Approx. 440 SF)
 - ACM TSI in crawlspace to be removed (Approx. 175 LF)

- LEGEND 2:**
- Containment Barrier
 - Air Filter Device (AFD)
 - AFD Exhaust Route
 - ER** Equipment (dirty) Room
 - SR** Shower Room
 - CR** Clean Room
 - BO₁** Waste Bags Wash Down Room
 - BO₂** Double Bagging of Waste Room

FIGURE 12

Asbestos-Containing Materials Abatement

Residential Duplex
 5 and 5-A Mather Drive, TSTC Campus
 3801 Campus Drive
 Waco, Texas 76705
BENAS Project No.: BA-11-0989



ENVIRONMENTAL CONSULTANTS
 P.O. BOX 739
 COPPELL, TEXAS 75019
 PHONE: (972)393-0128 FAX: (972) 393-0793

HATCHING & LOCATIONS FOR
**ASBESTOS-CONTAINING MATERIALS
 TO BE REMOVED**

Prepared for: Texas State Technical College (TSTC)
 Attention: Mr. Mike Ratliff, Project Manager
 Prepared by: Ephraim Okotcha "EO"
 TDSHS Licensed Asbestos Consultant No.: 10-5399

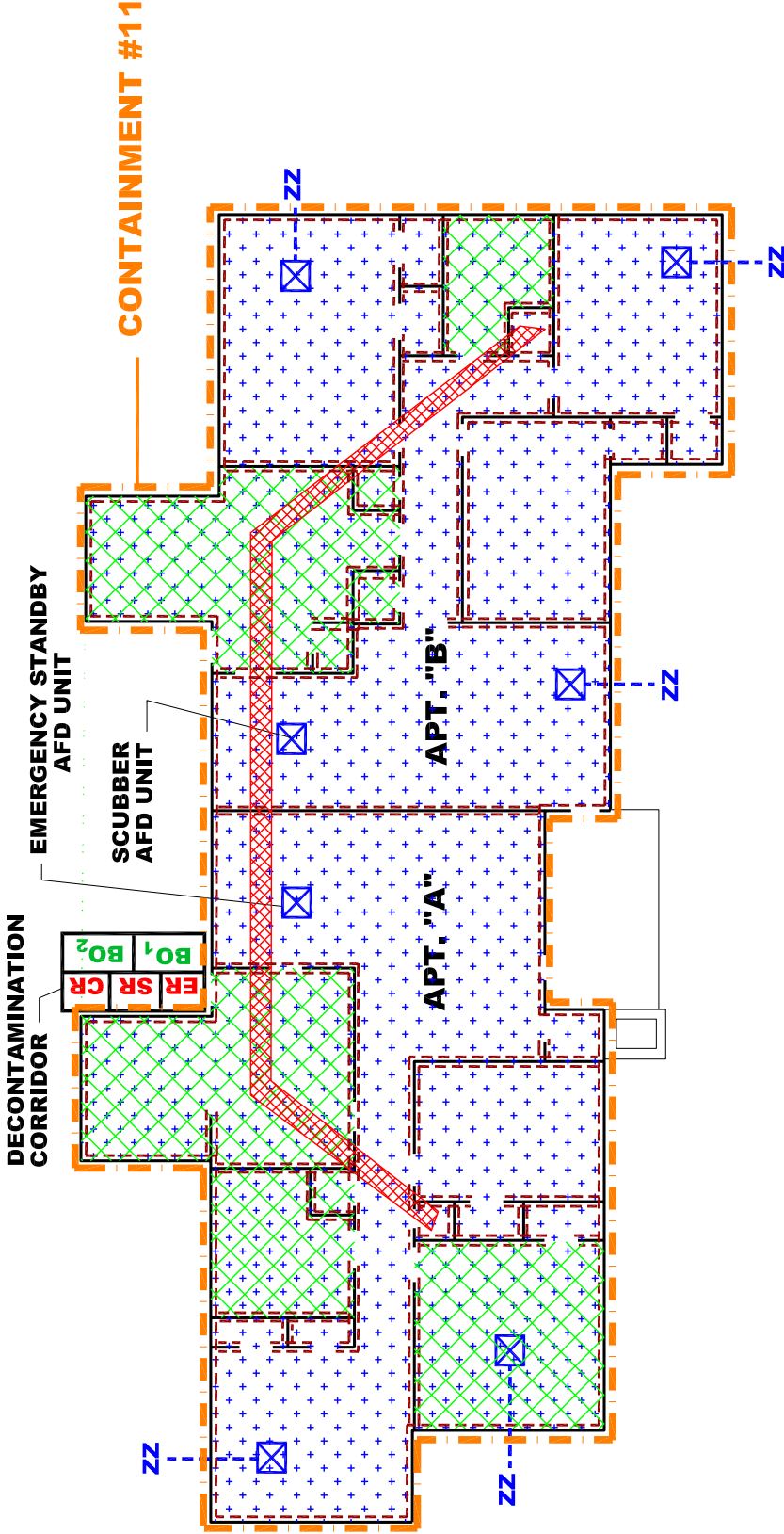

LEGEND 1:

- ACM Wall Texture & Joint Compound to be removed (Approx. 5,476 SF)
- ACM Ceiling Texture & Joint Compound to be removed (Approx. 1,908 SF)
- ACM Flooring Materials to be removed (Approx. 583 SF)
- ACM TSI in crawlspace to be removed (Approx. 175 LF)

LEGEND 2:

- Containment Barrier
- Air Filter Device (AFD)
- AFD Exhaust Route
- ER** Equipment (dirty) Room
- SR** Shower Room
- CR** Clean Room
- BO₁** Waste Bags Wash Down Room
- BO₂** Double Bagging of Waste Room

Asbestos-Containing Materials Abatement

Residential Duplex
 3 and 3A Mather Street, TSTC Campus
 3801 Campus Drive
 Waco, Texas 76705

BENAS Project No.: BA-11-0989



ENVIRONMENTAL CONSULTANTS
 P.O. BOX 739
 COPPELL, TEXAS 75019
 PHONE: (972)393-0128 FAX: (972) 393-0793

FIGURE 11

HATCHING & LOCATIONS FOR ASBESTOS-CONTAINING MATERIALS TO BE REMOVED

Prepared for: Texas State Technical College (TSTC)
 Attention: Mr. Mike Ratliff, Project Manager
 Prepared by: Ephraim Okotcha "EO"
 TDSHS Licensed Asbestos Consultant No.: 10-5399

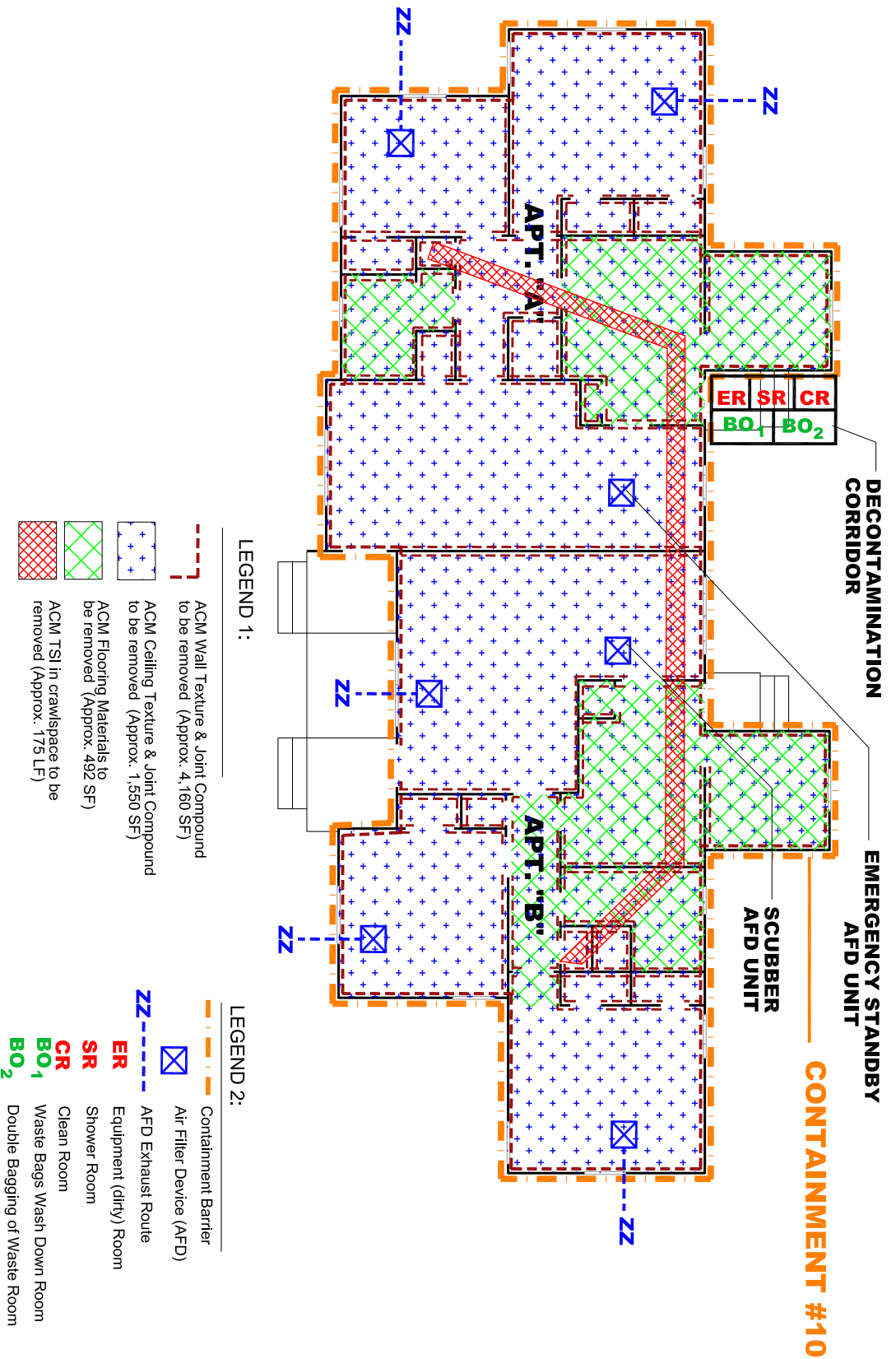

FIGURE 10

Asbestos-Containing Materials Abatement

Residential Duplex
 20 and 20-A Perrin Drive, TSTC Campus
 3801 Campus Drive
 Waco, Texas 76705
BENAS Project No.: BA-11-0989



BENAS
 Environmental Services, Inc.
 ENVIRONMENTAL CONSULTANTS
 P.O. BOX 739
 COPPELL, TEXAS 75019

PHONE: (972)393-0128 FAX: (972) 393-0793

HATCHING & LOCATIONS FOR ASBESTOS-CONTAINING MATERIALS TO BE REMOVED

Prepared for: Texas State Technical College (TSTC)
 Attention: Mr. Mike Ratliff, Project Manager
 Prepared by: Ephraim Okotcha "EO"
 TDSHS Licensed Asbestos Consultant No.: 10-5399

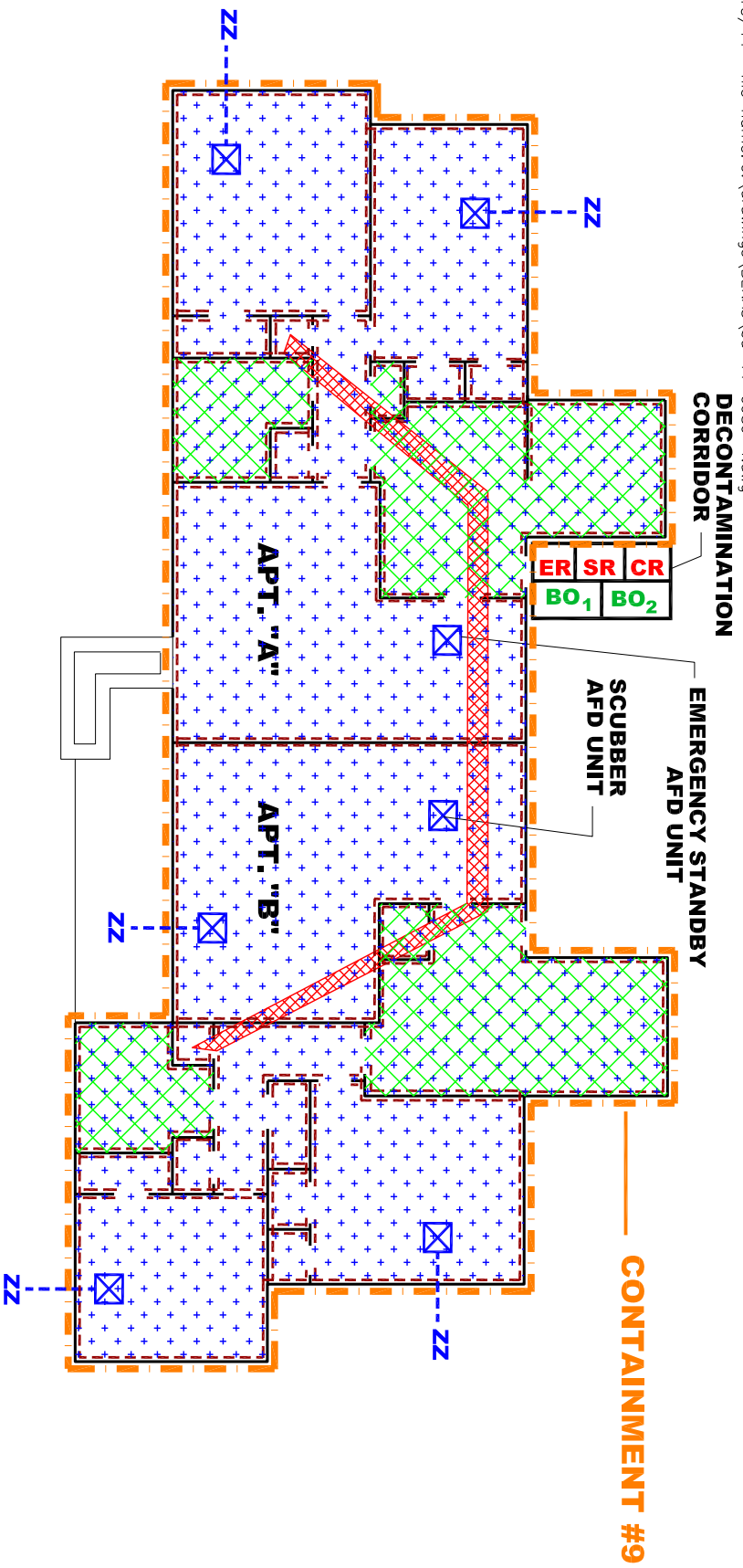

LEGEND 1:

- ACM Wall Texture & Joint Compound to be removed (Approx. 4,512 SF)
- ACM Ceiling Texture & Joint Compound to be removed (Approx. 1,346 SF)
- ACM Flooring Materials to be removed (Approx. 440 SF)
- ACM TSI in crawlspace to be removed (Approx. 175 LF)

LEGEND 2:

- Containment Barrier
- Air Filter Device (AFD)
- AFD Exhaust Route
- ER** Equipment (dirty) Room
- SR** Shower Room
- CR** Clean Room
- BO₁** Waste Bags Wash Down Room
- BO₂** Double Bagging of Waste Room

FIGURE 9

Asbestos-Containing Materials Abatement

Residential Duplex
 18 & 18A Perrin Street, TSTC Campus
 3801 Campus Drive
 Waco, Texas 76705
BENAS Project No.: BA-11-0989



BENAS
 Environmental Services, Inc.

ENVIRONMENTAL CONSULTANTS
 P.O. BOX 739
 COPPELL, TEXAS 75019
 PHONE: (972)393-0128 FAX: (972) 393-0793

HATCHING & LOCATIONS FOR ASBESTOS-CONTAINING MATERIALS TO BE REMOVED

Prepared for: Texas State Technical College (TSTC)
 Attention: Mr. Mike Ratliff, Project Manager
 Prepared by: Ephraim Okotcha "EO"
 TDSHS Licensed Asbestos Consultant No.: 10-5399

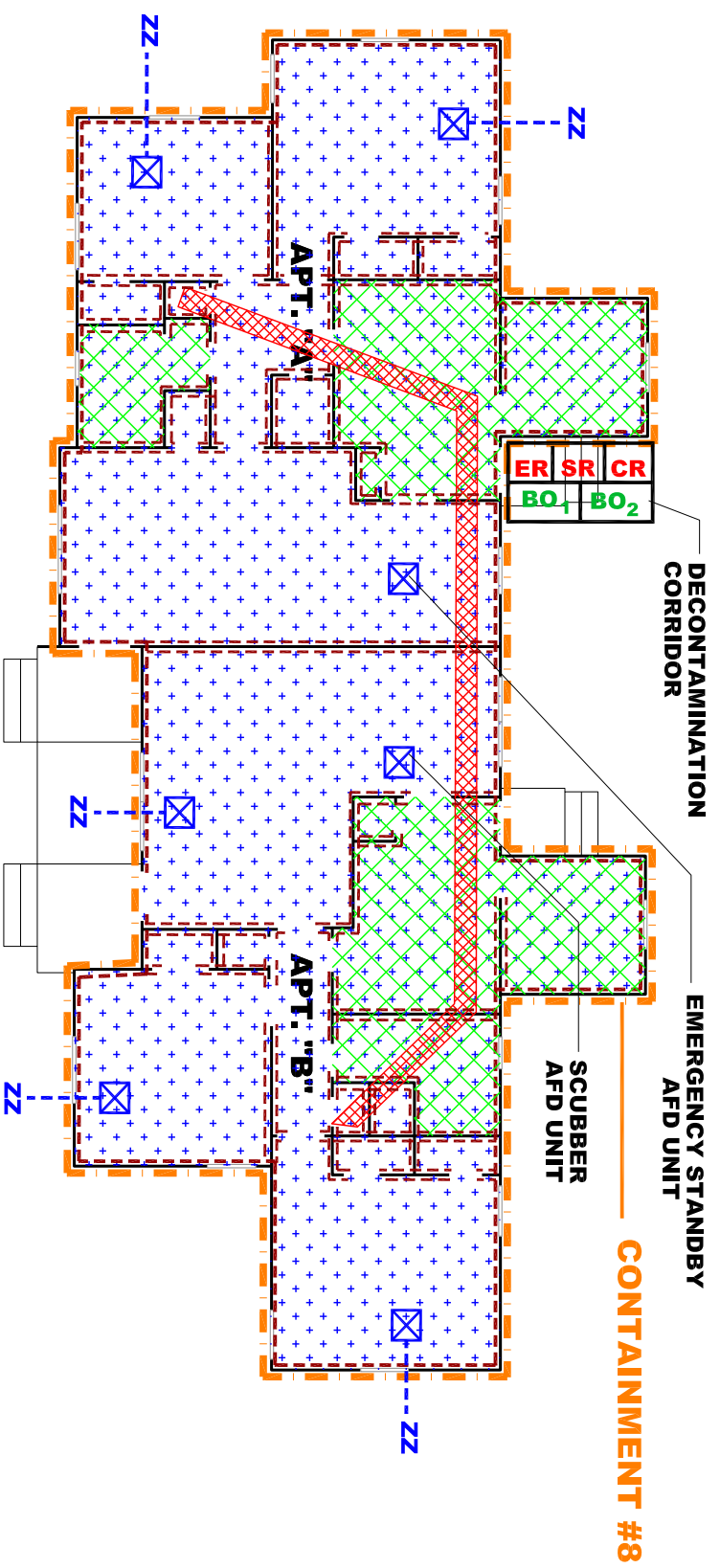

- LEGEND 1:**
- ACM Wall Texture & Joint Compound to be removed (Approx. 4,160 SF)
 - ACM Ceiling Texture & Joint Compound to be removed (Approx. 1,550 SF)
 - ACM Flooring Materials to be removed (Approx. 440 SF)
 - ACM TSI in crawlspace to be removed (Approx. 175 LF)

- LEGEND 2:**
- Containment Barrier
 - Air Filter Device (AFD)
 - AFD Exhaust Route
 - ER** Equipment (dirty) Room
 - SR** Shower Room
 - CR** Clean Room
 - BO₁** Waste Bags Wash Down Room
 - BO₂** Double Bagging of Waste Room

FIGURE 8

Asbestos-Containing Materials Abatement

Residential Duplex
 16 and 16-A Perrin Drive, TSTC Campus
 3801 Campus Drive
 Waco, Texas 76705
BENAS Project No.: BA-11-0989



BENAS
 Environmental Services, Inc.
 ENVIRONMENTAL CONSULTANTS
 P.O. BOX 739
 COPPELL, TEXAS 75019
 PHONE: (972)393-0128 FAX: (972) 393-0793

HATCHING & LOCATIONS FOR ASBESTOS-CONTAINING MATERIALS TO BE REMOVED

Prepared for: Texas State Technical College (TSTC)
 Attention: Mr. Mike Ratliff, Project Manager
 Prepared by: Ephraim Okotcha "EO"
 TDSHS Licensed Asbestos Consultant No.: 10-5399

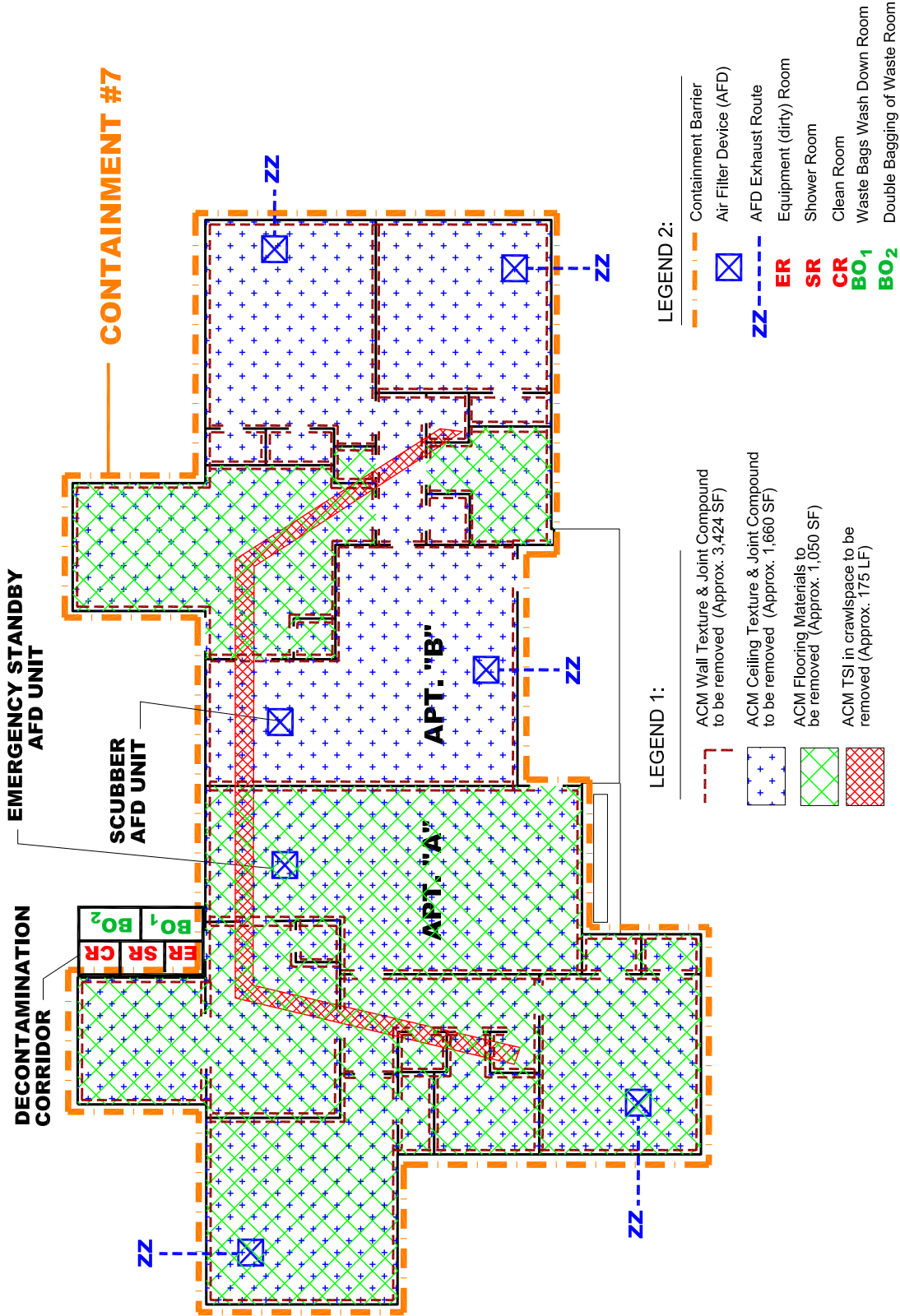

FIGURE 7

Asbestos-Containing Materials Abatement

Residential Duplex
 14 and 14A Perrin Street, TSTC Campus
 3801 Campus Drive
 Waco, Texas 76705

BENAS Project No.: BA-11-0989



ENVIRONMENTAL CONSULTANTS
 P.O. BOX 739
 COPPELL, TEXAS 75019

PHONE: (972)393-0128 FAX: (972) 393-0793

HATCHING & LOCATIONS FOR ASBESTOS-CONTAINING MATERIALS TO BE REMOVED

Prepared for: Texas State Technical College (TSTC)
 Attention: Mr. Mike Ratliff, Project Manager
 Prepared by: Ephraim Okotcha "EO"
 TDSHS Licensed Asbestos Consultant No.: 10-5399

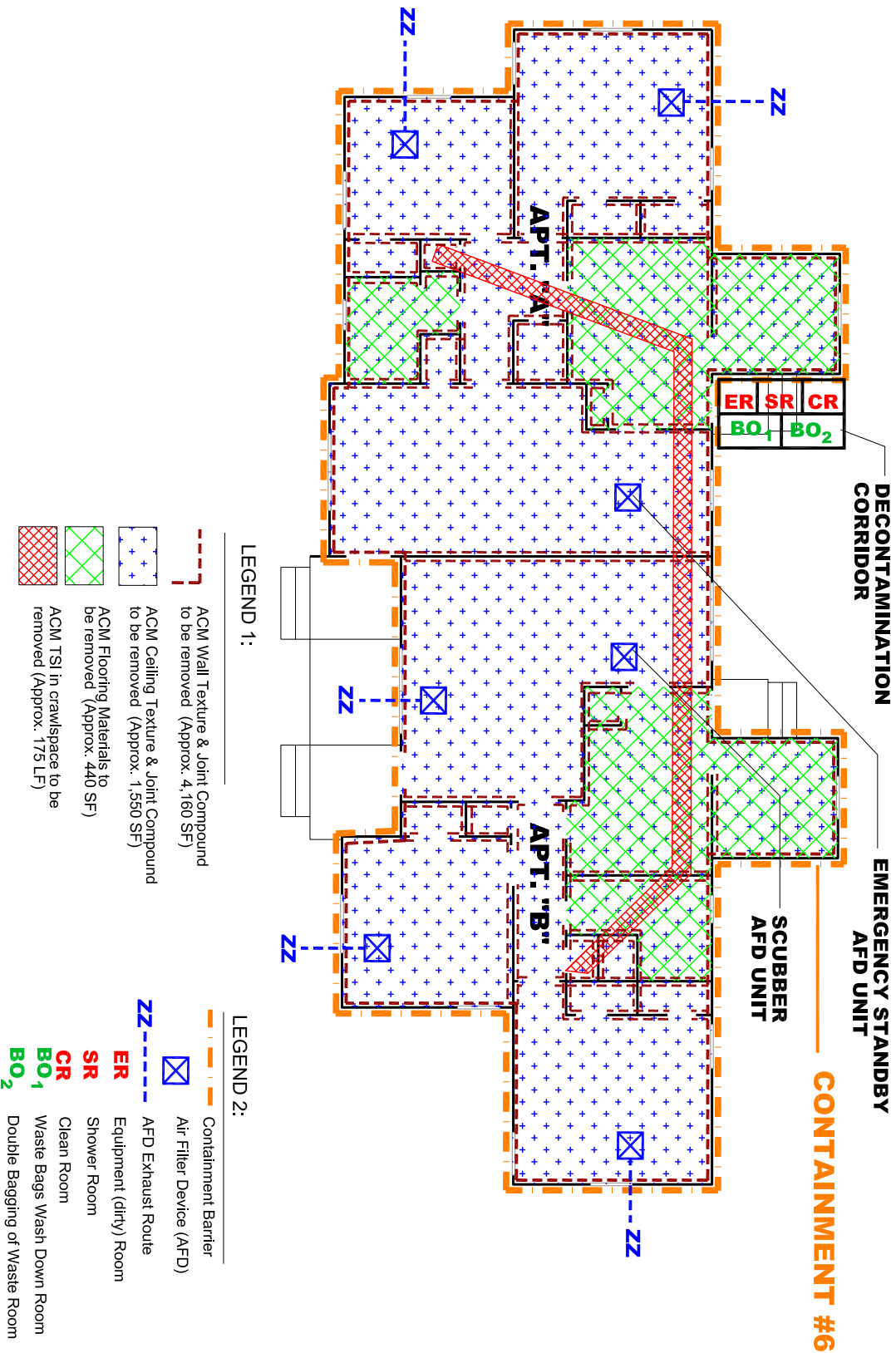

FIGURE 6

Asbestos-Containing Materials Abatement

Residential Duplex
 12 and 12-A Perrin Drive, TSTC Campus
 3801 Campus Drive
 Waco, Texas 76705
BENAS Project No.: BA-11-0989



BENAS
 Environmental Services, Inc.
 ENVIRONMENTAL CONSULTANTS
 P.O. BOX 739
 COPPELL, TEXAS 75019
 PHONE: (972)393-0128 FAX: (972) 393-0793

HATCHING & LOCATIONS FOR ASBESTOS-CONTAINING MATERIALS TO BE REMOVED

Prepared for: Texas State Technical College (TSTC)
 Attention: Mr. Mike Ratliff, Project Manager
 Prepared by: Ephraim Okotcha "EO"
 TDSHS Licensed Asbestos Consultant No.: 10-5399

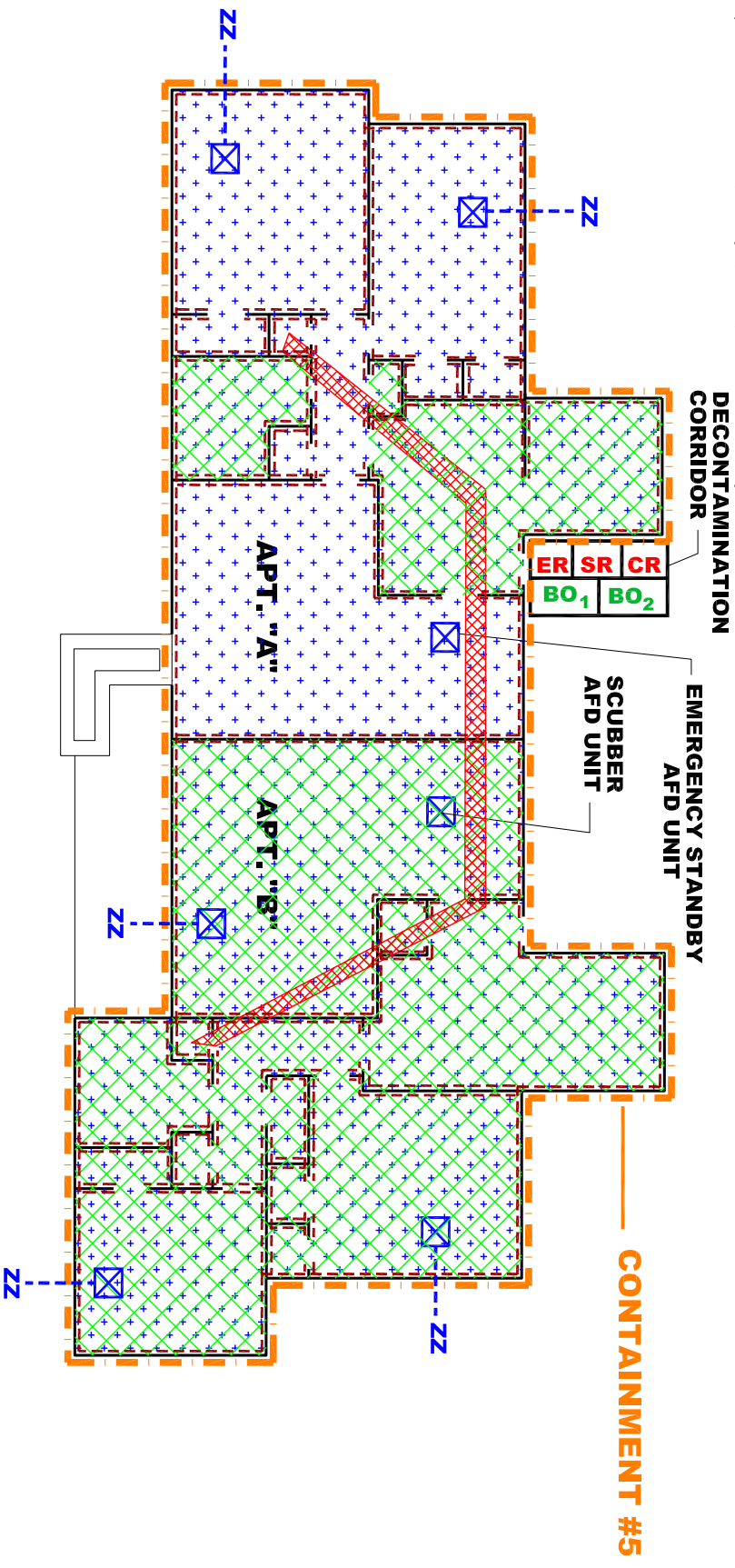

- LEGEND 1:**
- ACM Wall Texture & Joint Compound to be removed (Approx. 4,512 SF)
 - ACM Ceiling Texture & Joint Compound to be removed (Approx. 1,346 SF)
 - ACM Flooring Materials to be removed (Approx. 894 SF)
 - ACM TSI in crawlspace to be removed (Approx. 175 LF)
- LEGEND 2:**
- Containment Barrier
 - Air Filter Device (AFD)
 - AFD Exhaust Route
 - ER** Equipment (dirty) Room
 - SR** Shower Room
 - CR** Clean Room
 - BO₁** Waste Bags Wash Down Room
 - BO₂** Double Bagging of Waste Room

FIGURE 5

Asbestos-Containing Materials Abatement

Residential Duplex
 10 & 10A Perrin Street, TSTC Campus
 3801 Campus Drive
 Waco, Texas 76705
BENAS Project No.: BA-11-0989



BENAS
 Environmental Services, Inc.
 ENVIRONMENTAL CONSULTANTS
 P.O. BOX 739
 COPPELL, TEXAS 75019
 PHONE: (972)393-0128 FAX: (972) 393-0793

HATCHING & LOCATIONS FOR ASBESTOS-CONTAINING MATERIALS TO BE REMOVED

Prepared for: Texas State Technical College (TSTC)
 Attention: Mr. Mike Ratliff, Project Manager
 Prepared by: Ephraim Okotcha "EO"
 TDSHS Licensed Asbestos Consultant No.: 10-5399

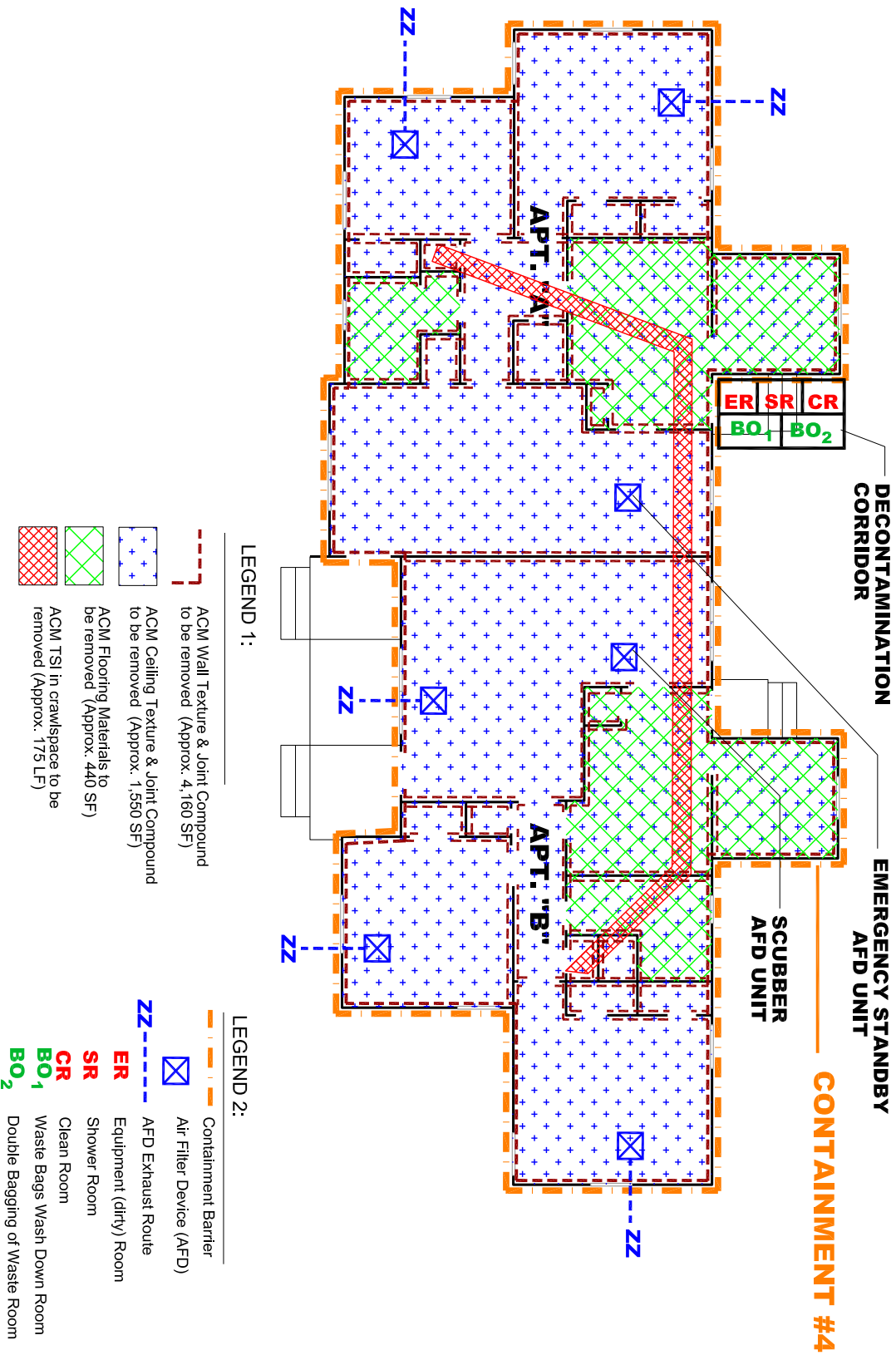

FIGURE 4

Asbestos-Containing Materials Abatement

Residential Duplex
 8 and 8-A Perrin Drive, TSTC Campus
 3801 Campus Drive
 Waco, Texas 76705
BENAS Project No.: BA-11-0989



BENAS
 Environmental Services, Inc.
 ENVIRONMENTAL CONSULTANTS
 P.O. BOX 739
 COPPELL, TEXAS 75019
 PHONE: (972)393-0128 FAX: (972) 393-0793

HATCHING & LOCATIONS FOR ASBESTOS-CONTAINING MATERIALS TO BE REMOVED

Prepared for: Texas State Technical College (TSTC)
 Attention: Mr. Mike Ratliff, Project Manager
 Prepared by: Ephraim Okotcha "EO"
 TDSHS Licensed Asbestos Consultant No.: 10-5399

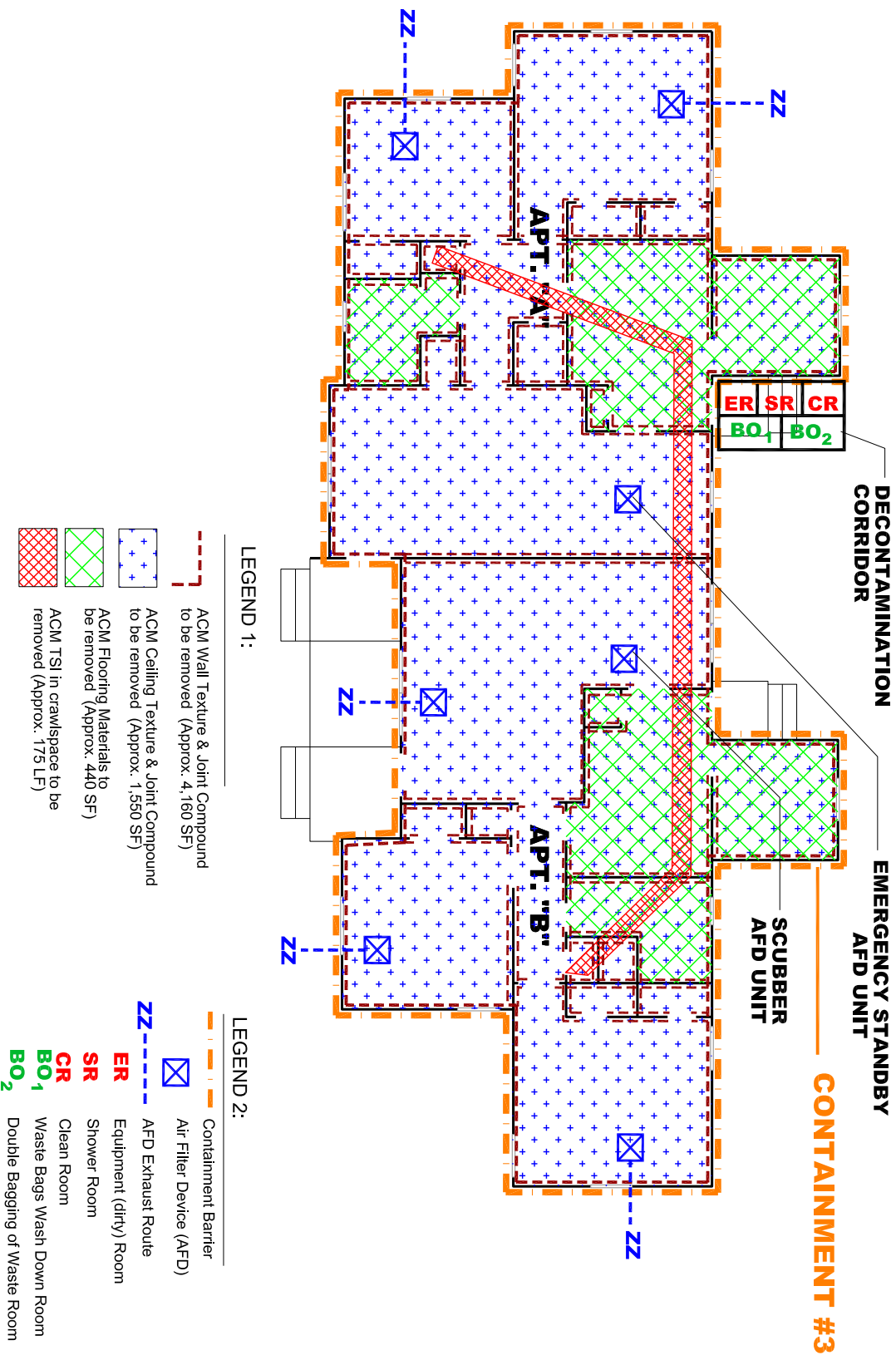

FIGURE 3

Asbestos-Containing Materials Abatement

Residential Duplex
6 and 6-A Perrin Drive, TSTC Campus
3801 Campus Drive
Waco, Texas 76705
BENAS Project No.: BA-11-0989



BENAS
Environmental Services, Inc.
ENVIRONMENTAL CONSULTANTS
P.O. BOX 739
COPPELL, TEXAS 75019
PHONE: (972)393-0128 FAX: (972) 393-0793

HATCHING & LOCATIONS FOR ASBESTOS-CONTAINING MATERIALS TO BE REMOVED

Prepared for: Texas State Technical College (TSTC)
Attention: Mr. Mike Ratliff, Project Manager
Prepared by: Ephraim Okotcha "EO"
TDSHS Licensed Asbestos Consultant No.: 10-5399

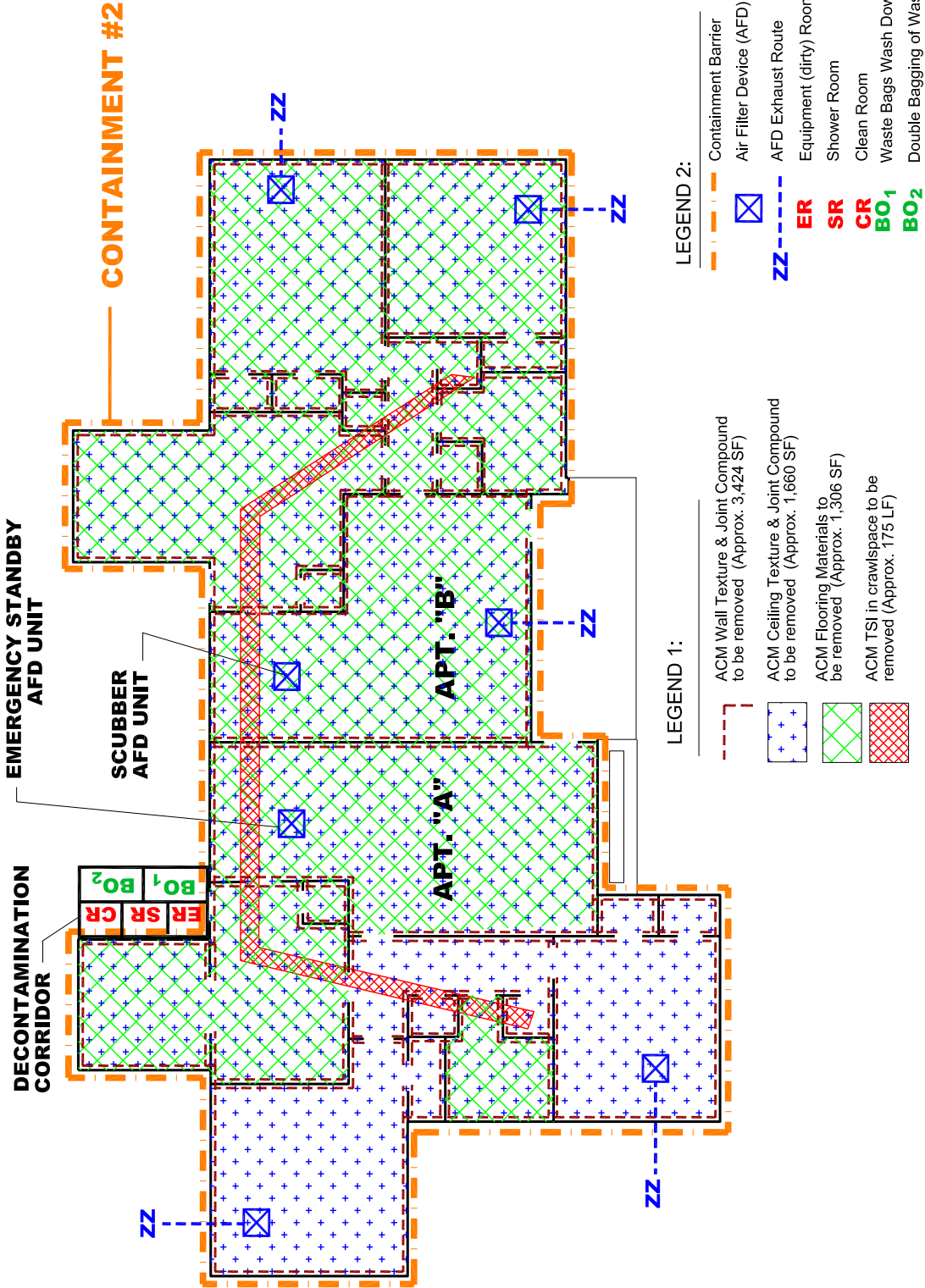

FIGURE 2

Asbestos-Containing Materials Abatement
 Residential Duplex
 4 and 4A Perrin Street, TSTC Campus
 3801 Campus Drive
 Waco, Texas 76705
BENAS Project No.: BA-11-0989

BENAS
 Environmental Services, Inc.
 ENVIRONMENTAL CONSULTANTS
 P.O. BOX 739
 COPPELL, TEXAS 75019
 PHONE: (972)393-0128 FAX: (972) 393-0793

HATCHING & LOCATIONS FOR ASBESTOS-CONTAINING MATERIALS TO BE REMOVED
 Prepared for: Texas State Technical College (TSTC)
 Attention: Mr. Mike Raliff, Project Manager
 Prepared by: Ephraim Okotcha "EO"
 TDSHS Licensed Asbestos Consultant No.: 10-5399

DECONTAMINATION CORRIDOR

EMERGENCY STANDBY AFD UNIT

SCUBBER AFD UNIT

CONTAINMENT #22

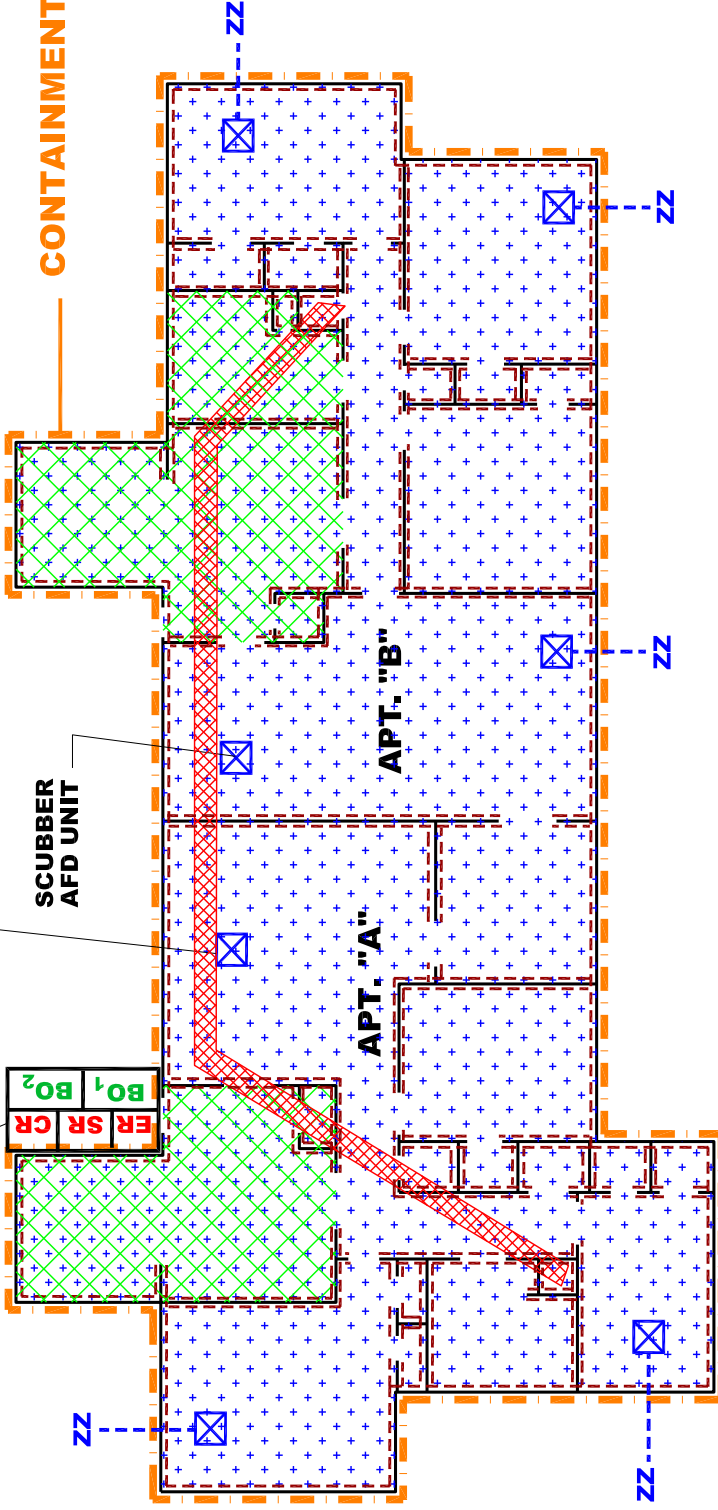

LEGEND 1:

- ACM Wall Texture & Joint Compound to be removed (Approx. 4,704 SF)
- ACM Ceiling Texture & Joint Compound to be removed (Approx. 1,588 SF)
- ACM Flooring Materials to be removed (Approx. 405 SF)
- ACM TSI in crawlspace to be removed (Approx. 175 LF)

LEGEND 2:

- Containment Barrier
- Air Filter Device (AFD)
- AFD Exhaust Route
- Equipment (dirty) Room
- Shower Room
- Clean Room
- Waste Bags Wash Down Room
- Double Bagging of Waste Room

FIGURE 22

Asbestos-Containing Materials Abatement

Residential Duplex
77 & 77A Bolling Street, TSTC Campus
3801 Campus Drive
Waco, Texas 76705

BENAS Project No.: BA-11-0989



ENVIRONMENTAL CONSULTANTS

P.O. BOX 739

COPPELL, TEXAS 75019

PHONE: (972)393-0128

FAX: (972) 393-0793

HATCHING & LOCATIONS FOR ASBESTOS-CONTAINING MATERIALS TO BE REMOVED

Prepared for: Texas State Technical College (TSTC)

Attention: Mr. Mike Ratliff, Project Manager

Prepared by: Ephraim Okotcha "EO"

TDSHS Licensed Asbestos Consultant No.: 10-5399